

窄巷道 GLSL.F 系统安装 指导手册

***所有联接，必须使用防松螺栓，
杜绝事故！**

配件清单

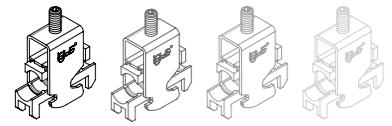

CFXL

*



沉头螺钉 M6x16 8.8 DIN 7791
六角防松螺栓 M6 DIN 985
垫片 DIN 9021-6,4

*

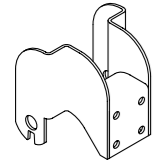

1x

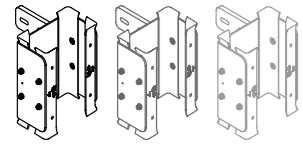

*

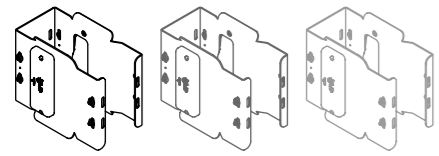

*

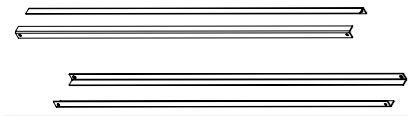

*

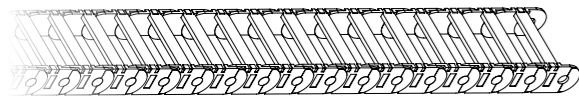

拖链

1x

数量凭订货清单，可与图纸核对

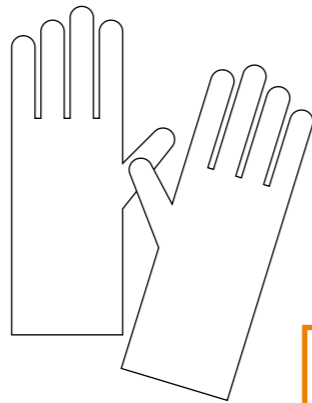
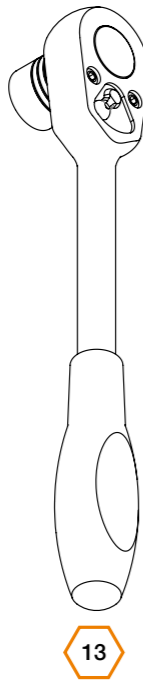
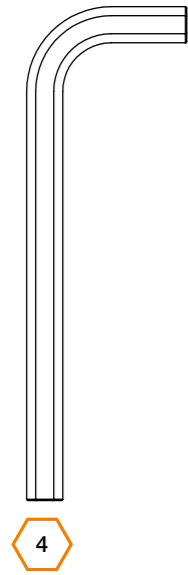
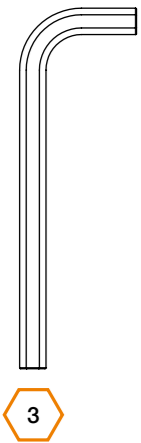

用户自备

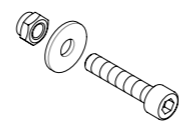

M8 - 8.8硬度等级

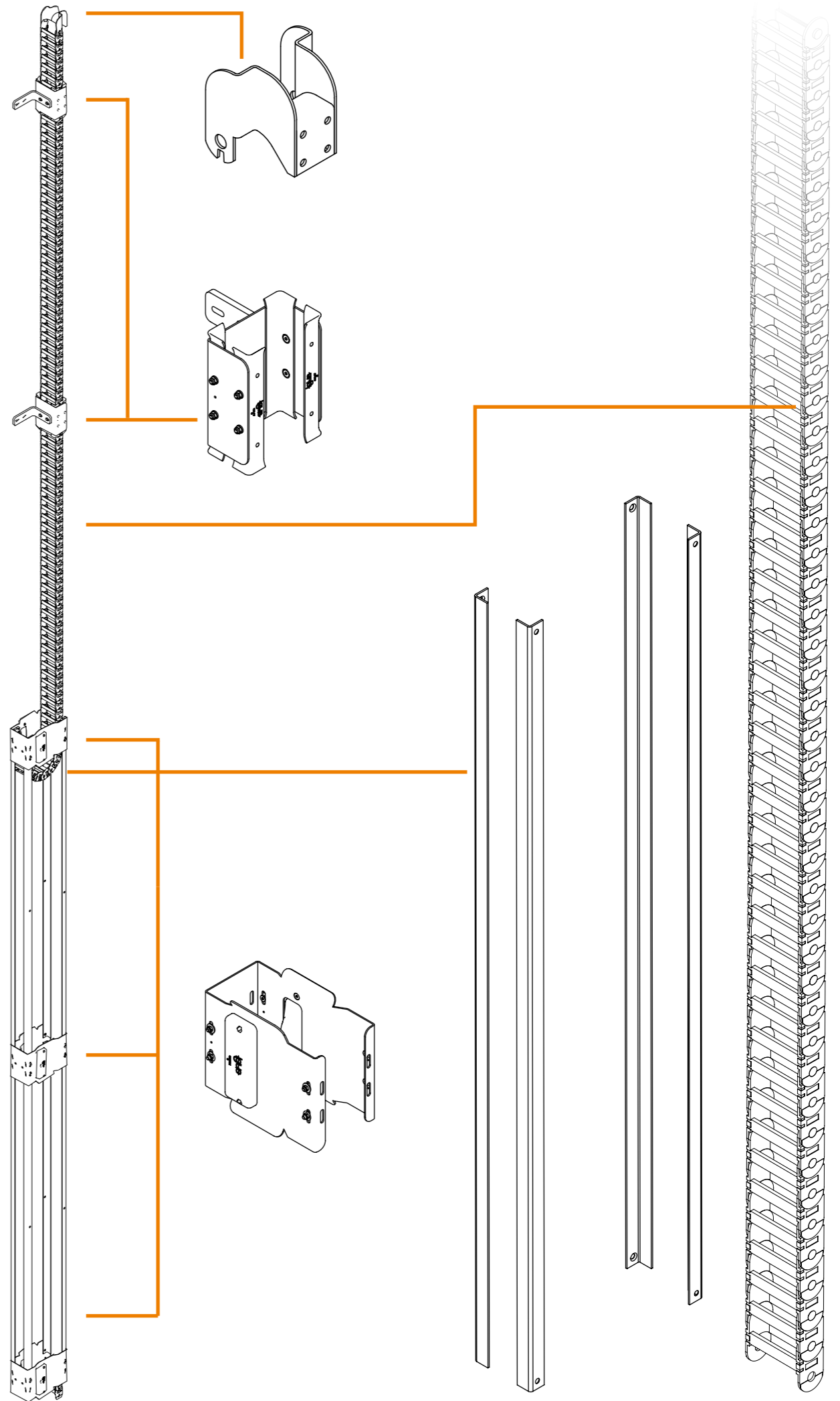

1

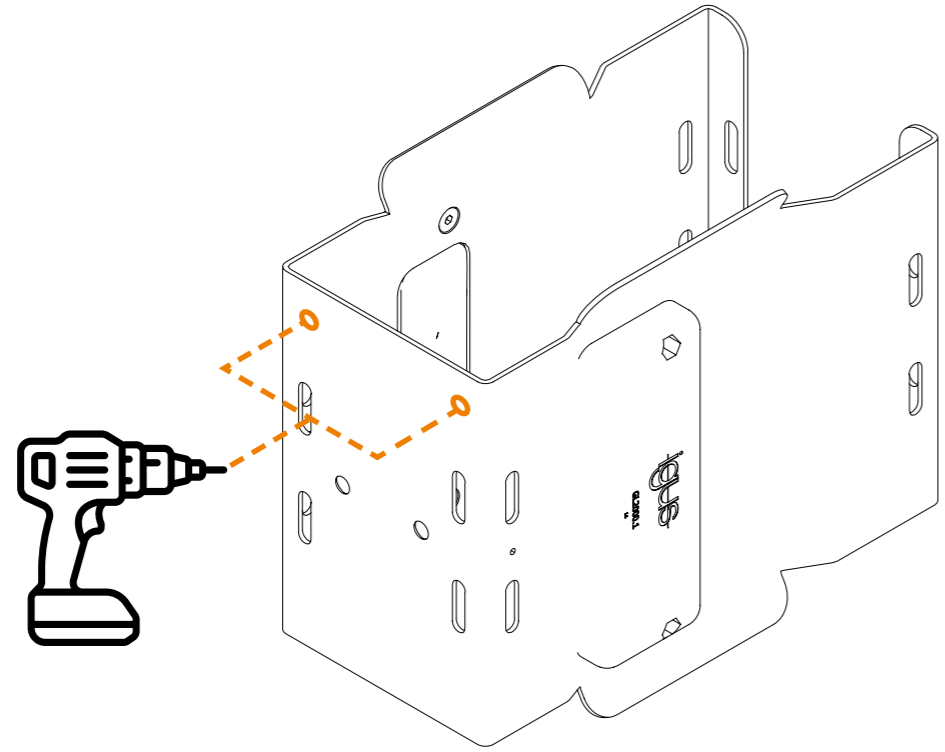

2

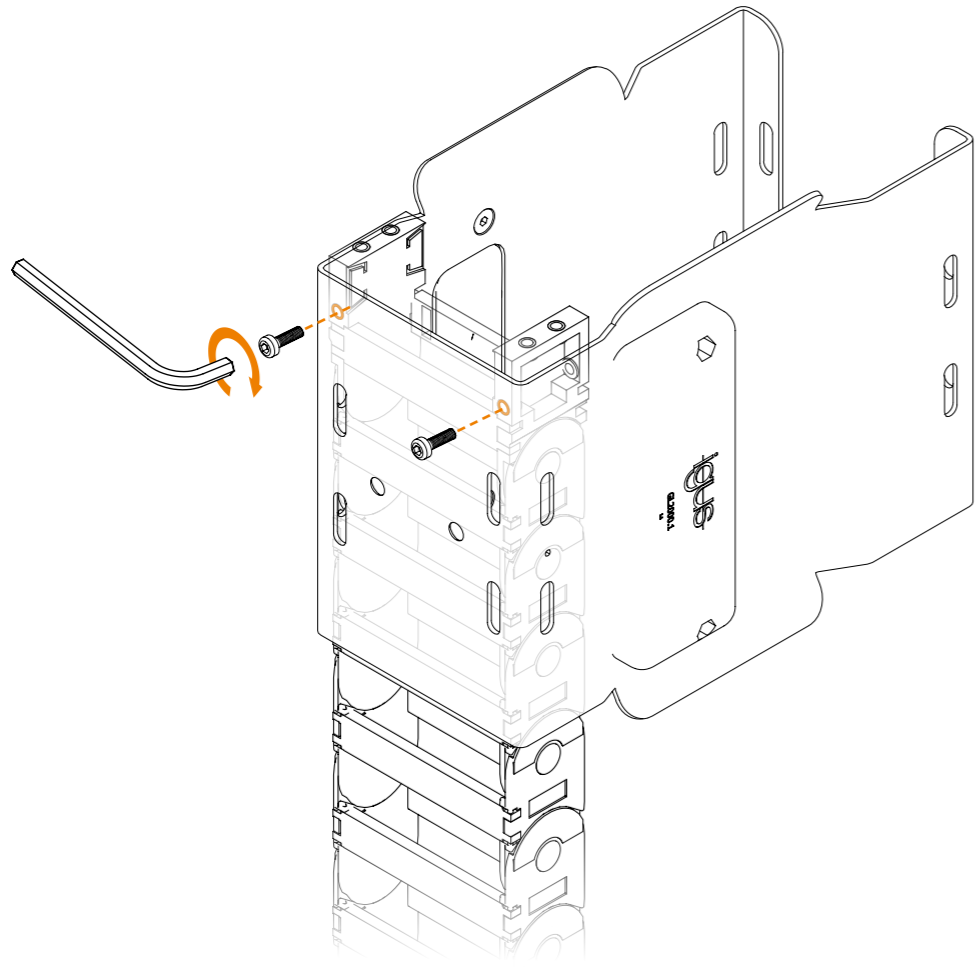

1

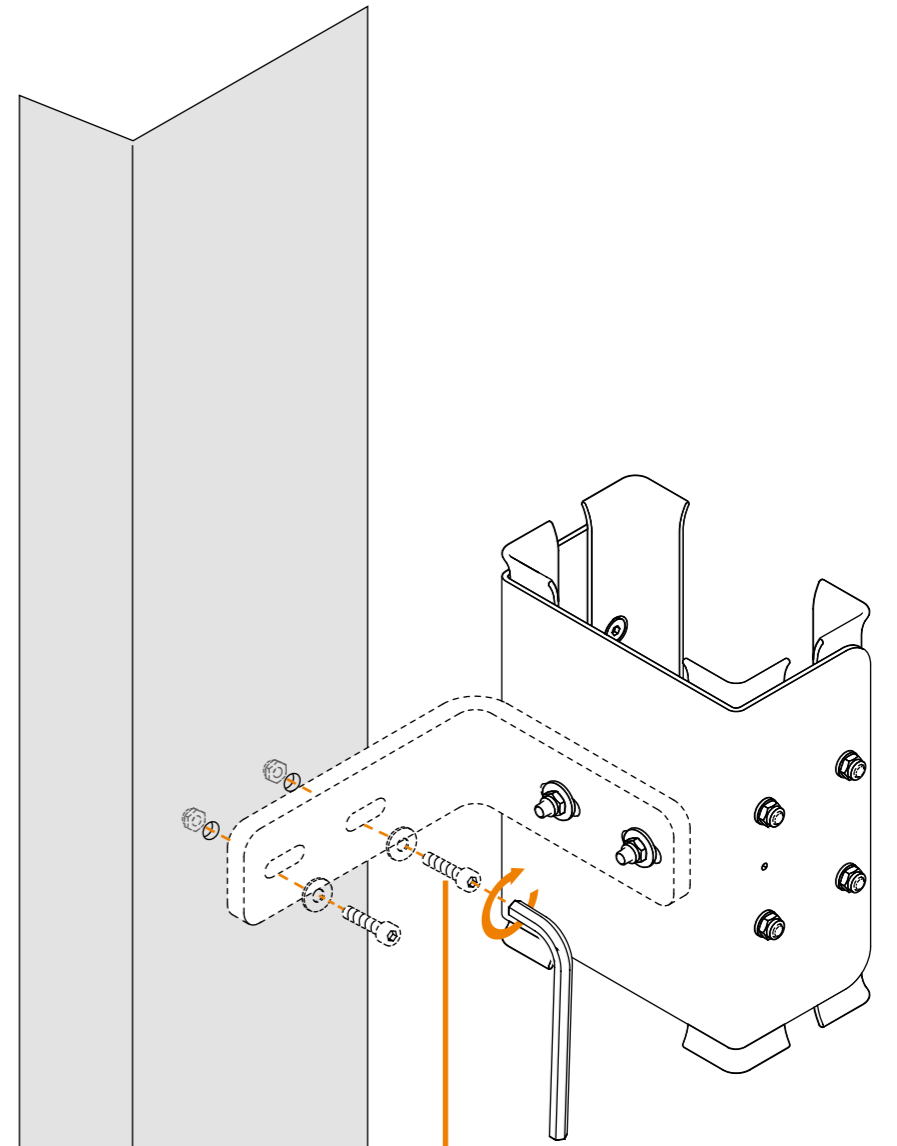

M8 - 8.8, 用户自备

2

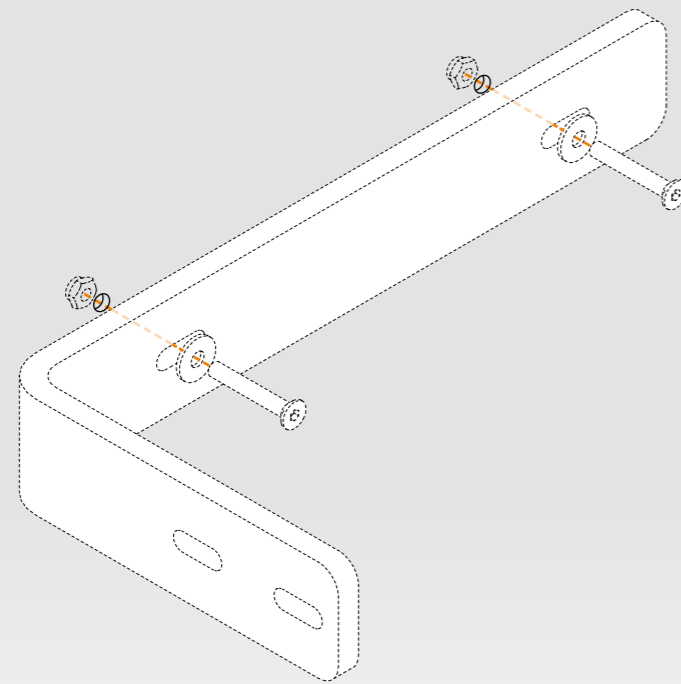

M5 - 用户自备

3

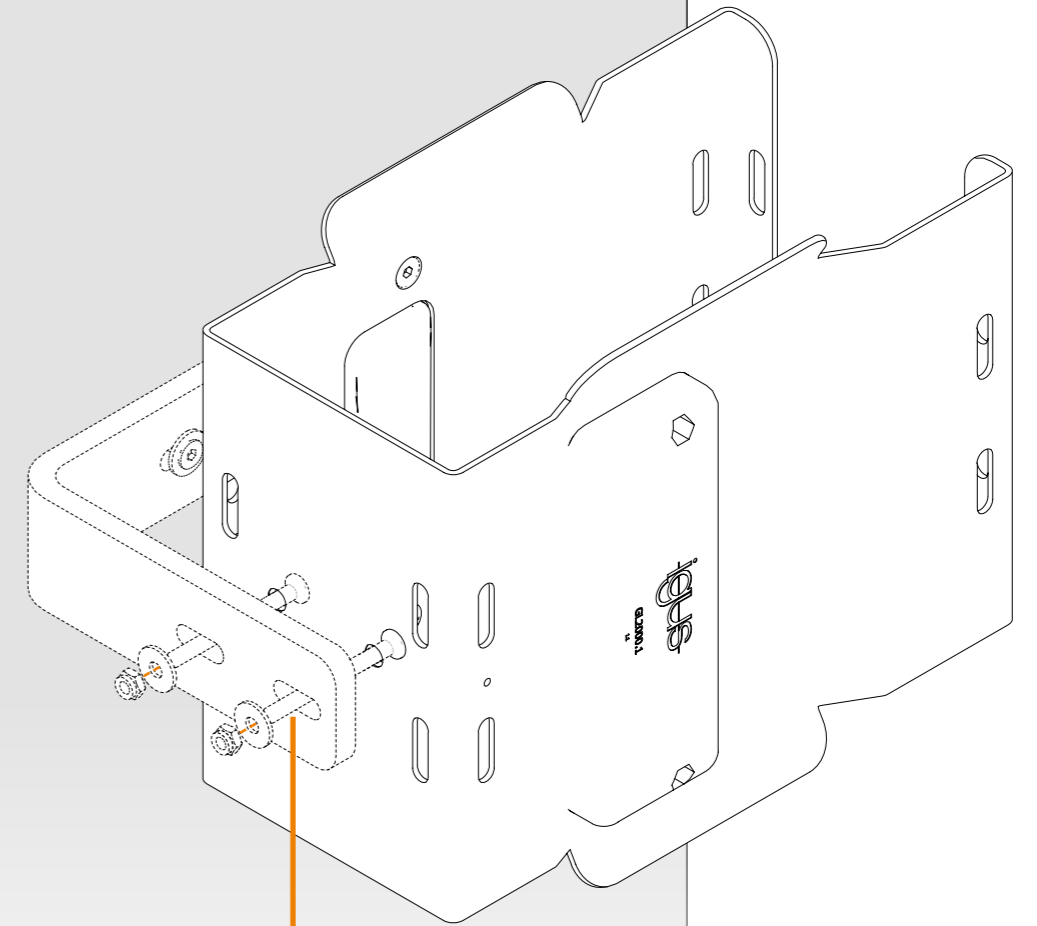

M5 - 用户自备

4



碰撞的危险!
每个引导支架的位置
要检查，相互之间保
持对齐。

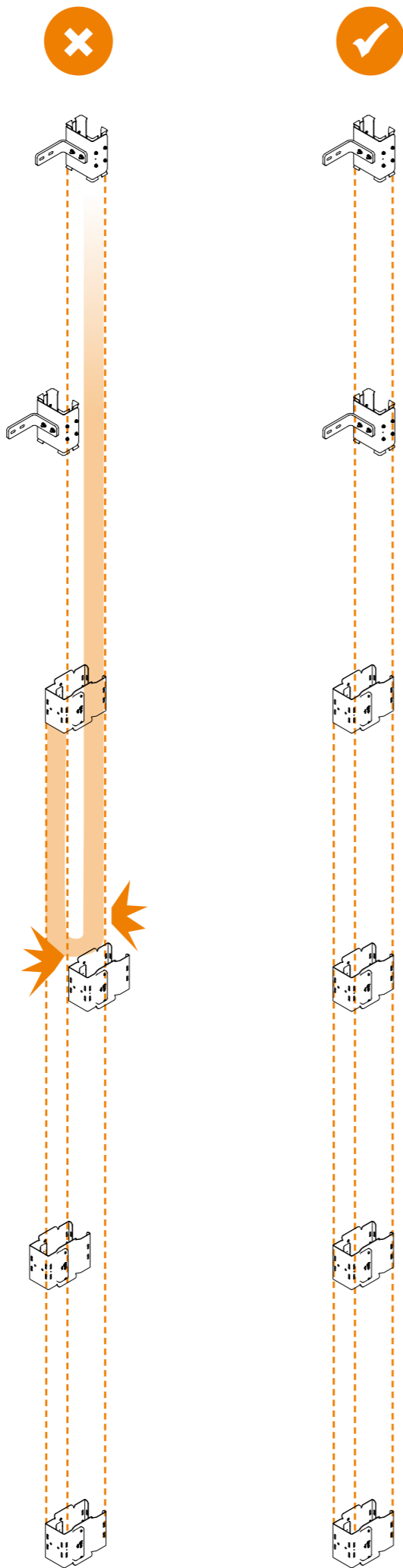

5

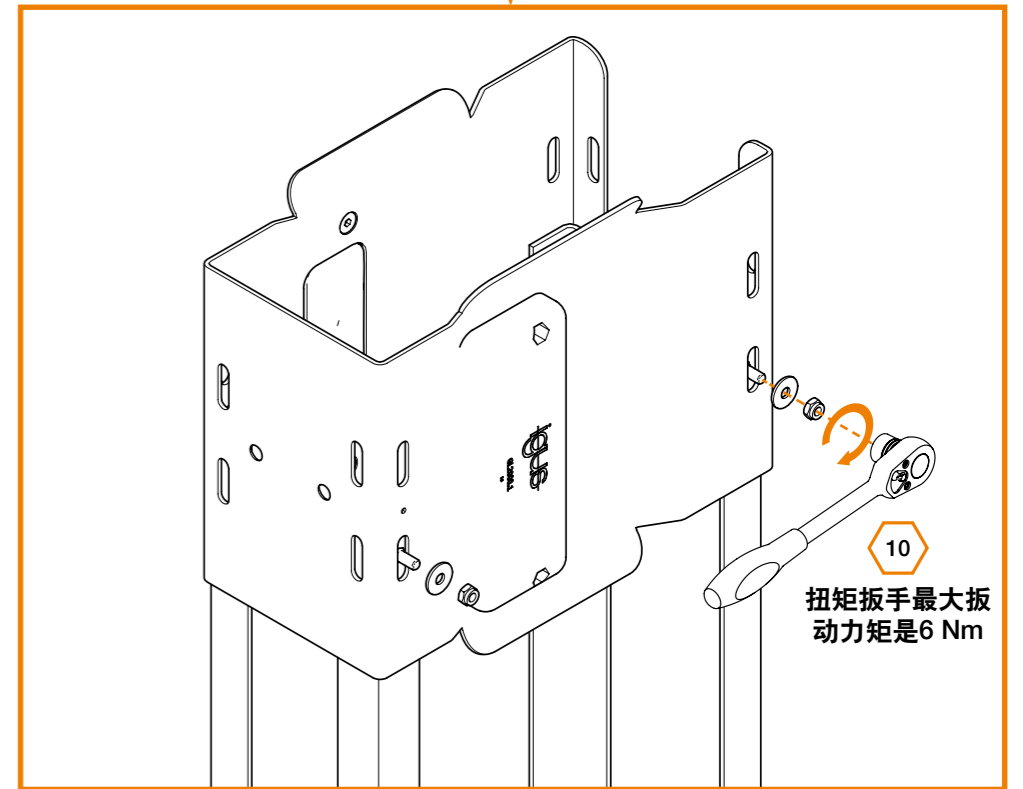
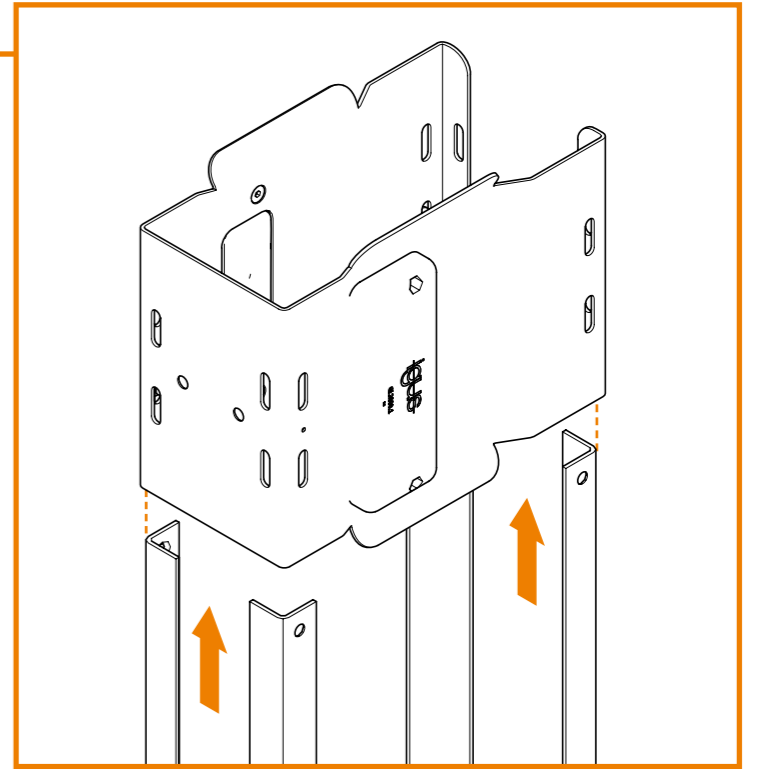
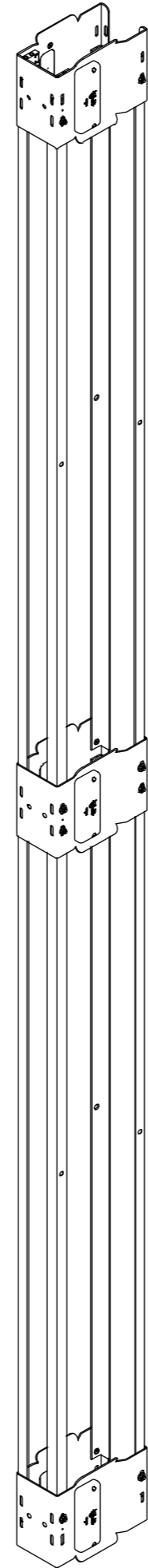

6

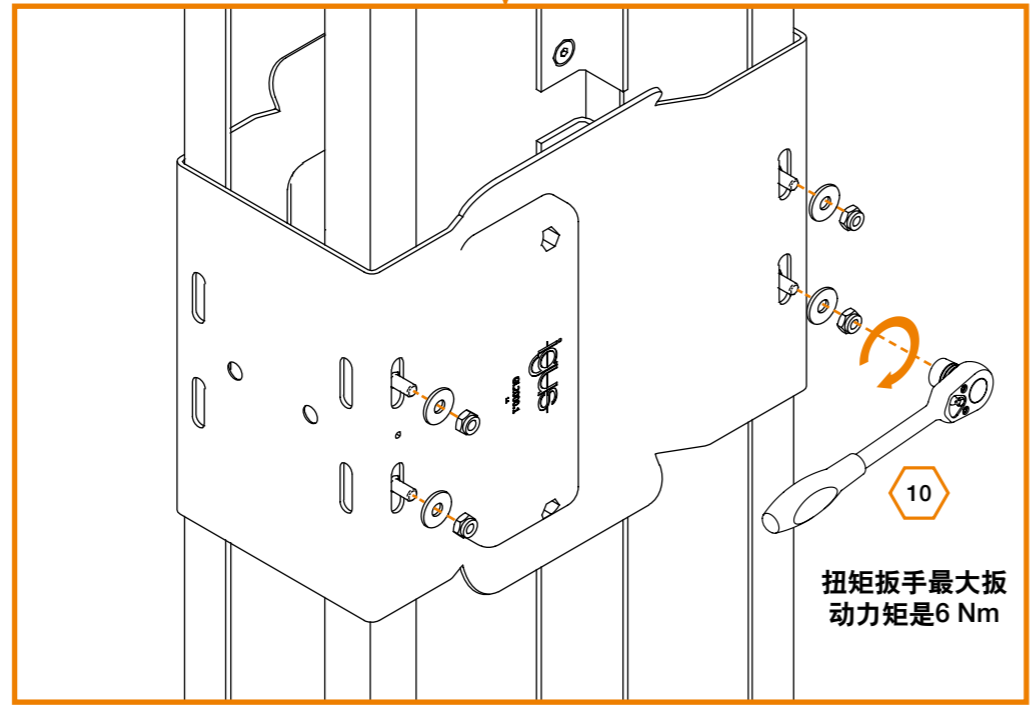
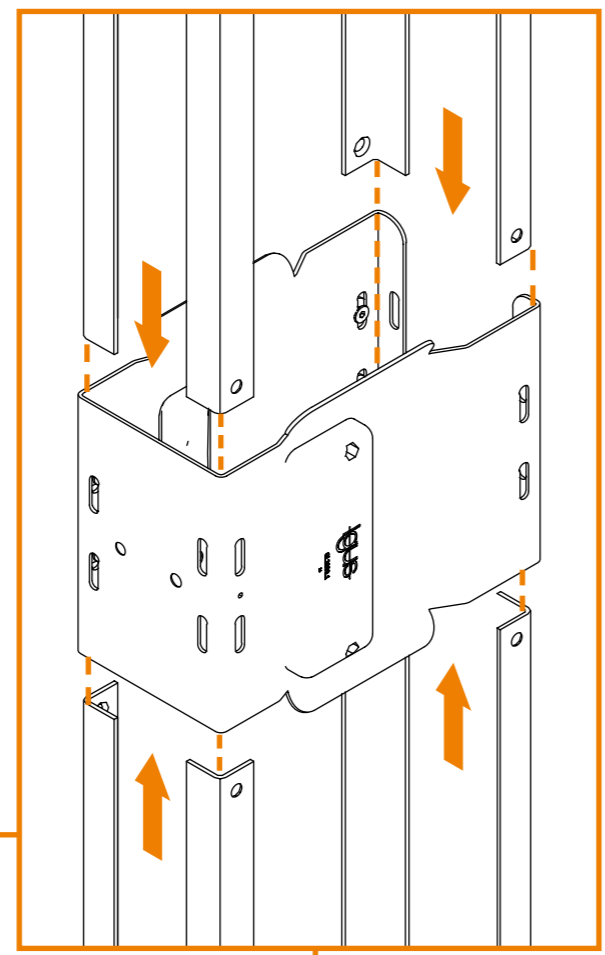
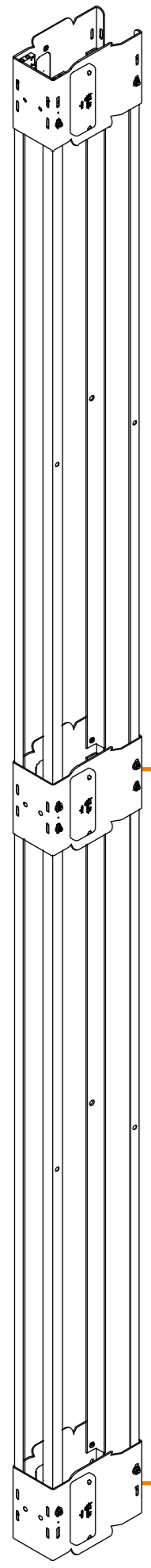

1

2

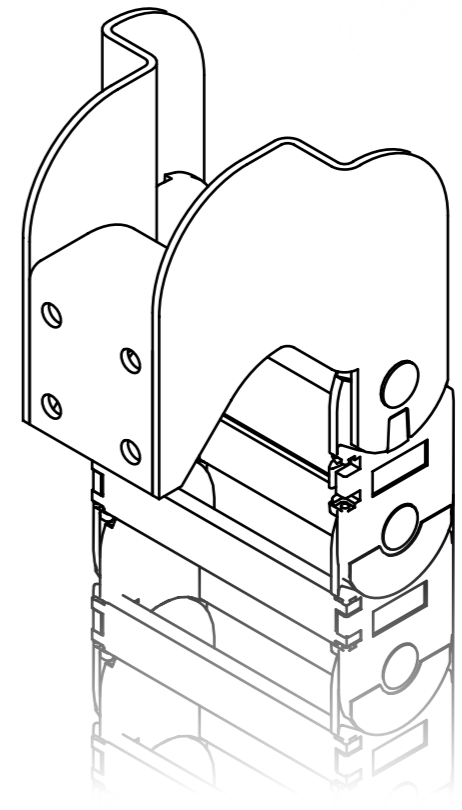
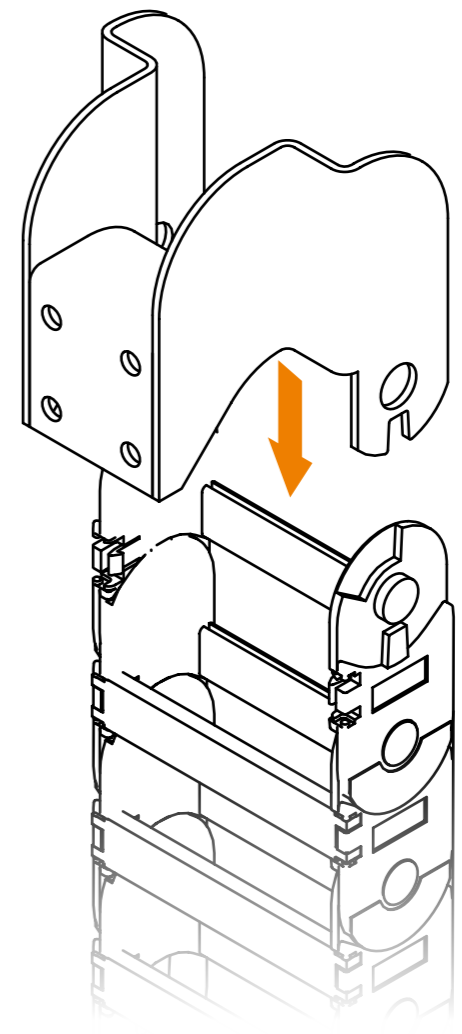

受控

1

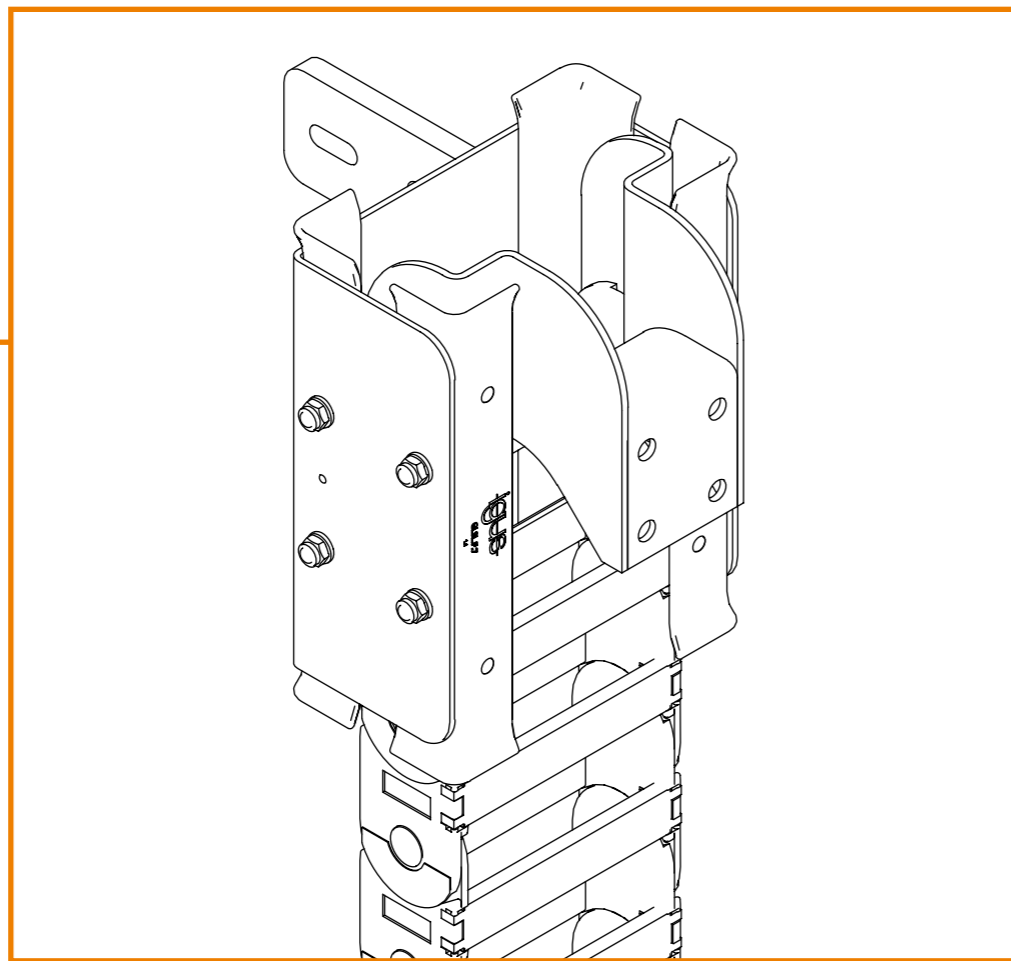
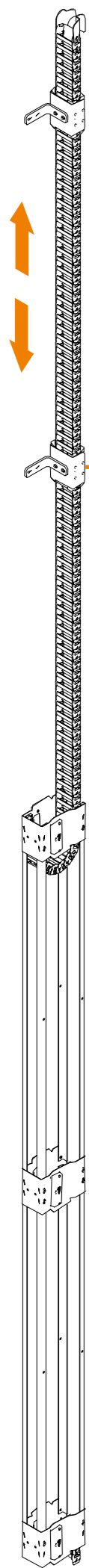

俯视图

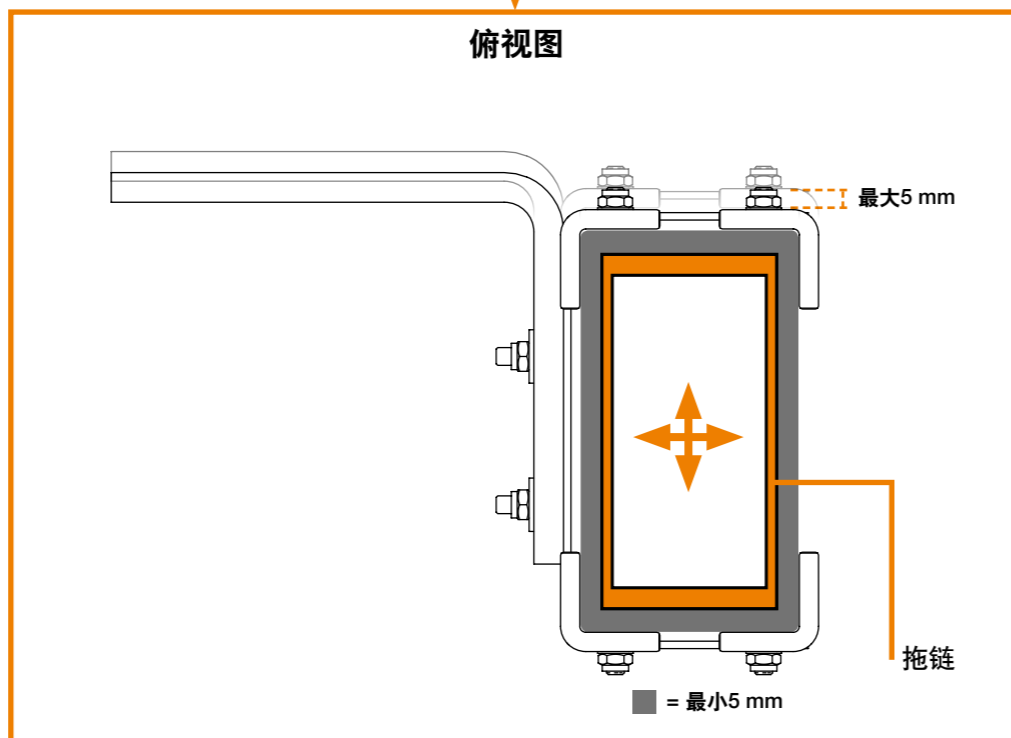

受控

2

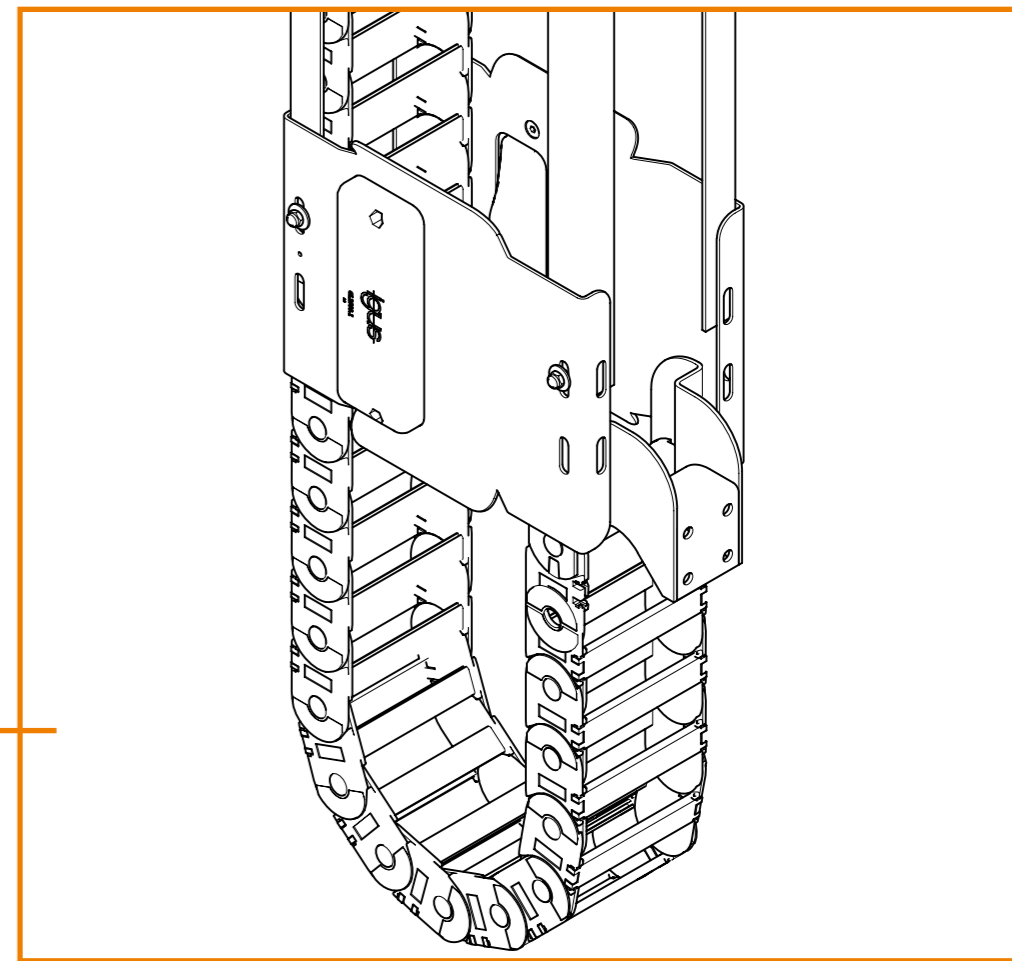
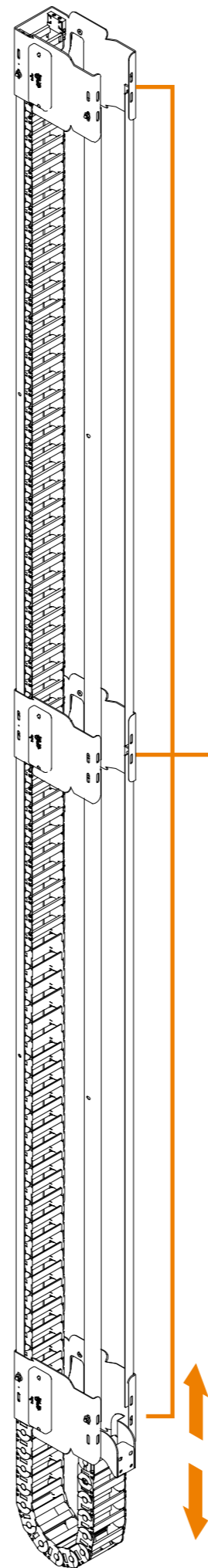

俯视图

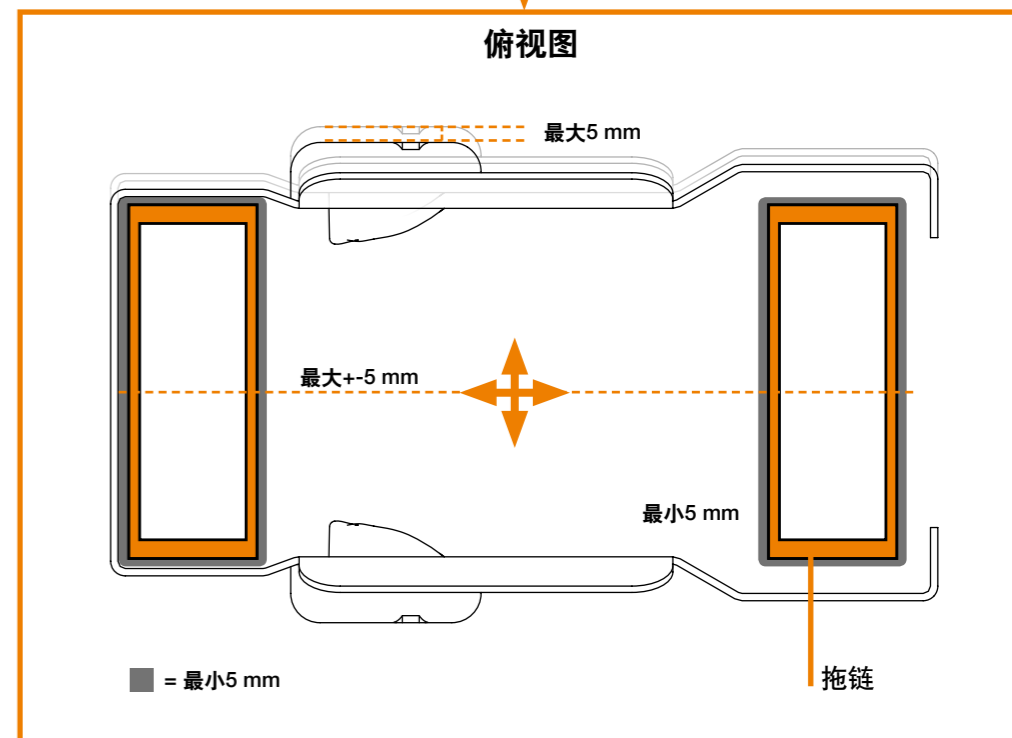

受控

3

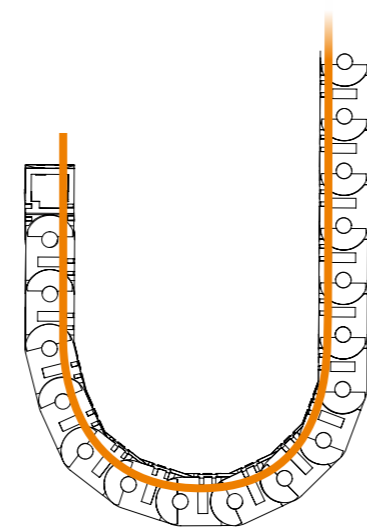
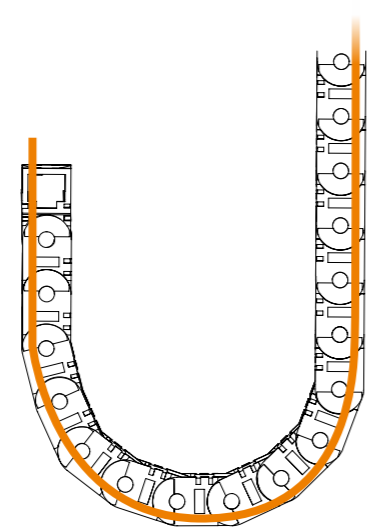
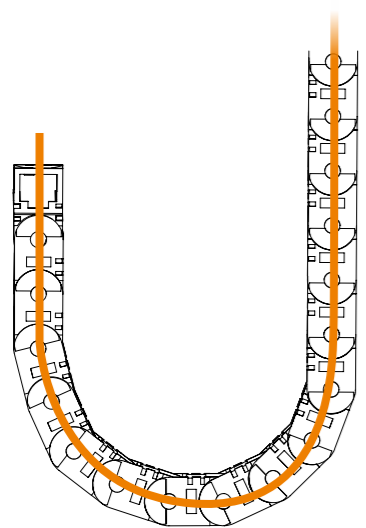

安装3个月后检查一次，之后每年检查一次。



易格斯（上海）拖链系统有限公司
上海市奉贤区环城北路50号
邮编：201401
电话：021-8036 6999
传真：021-8036 6116
邮箱：cnmaster@igus.net
<https://www.igus.com.cn>

易格斯保留最终解释权！ MAT0074841.14 截至05/2020
技术参数解释权归易格斯所有！